

April 15th, 2011
Flad Architects Construction Submission

1. Conceptual Images of Team Structure

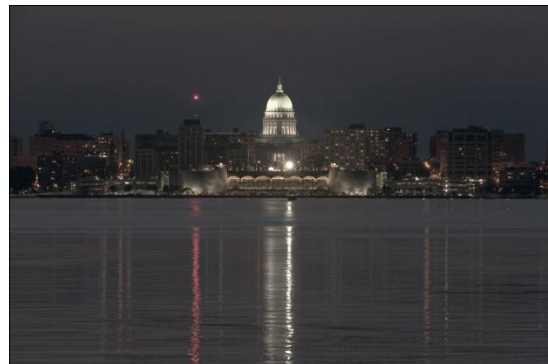
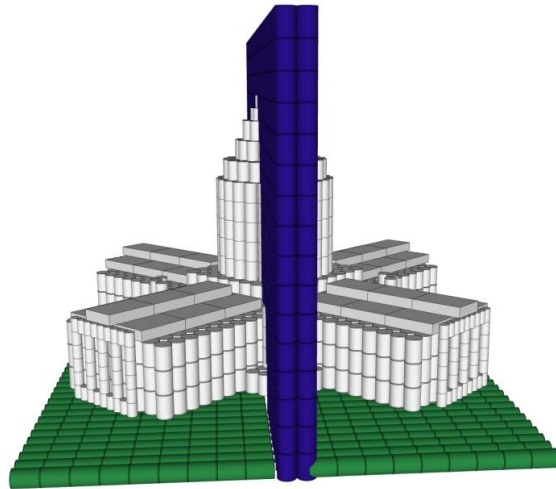
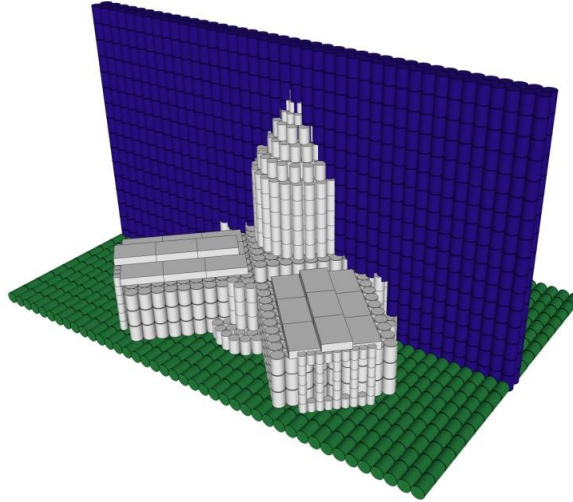

One side of "can wall" will depict the capital during the day, the other at night.

2. Dimensions of Team's Structure:

8' W x 12' L x 6' 8" H

3. A list of Building Materials:

Confirmed: Cans, Cereal boxes

Possibilities: Other packaged goods, cardboard, foamcore, battery operated lights, etc.

4. Estimate of canned goods, etc. that will be used:

Current Can Count Estimate:

Total Cans - approx. 3450

Cereal Boxes - approx. 36

4. Food Distributor's used:

Capital Centre Market

*Still waiting to hear back from other possible vendors willing to donate.

5. Information for Structure Signage

a) Firm / Organization Name: Flad Architects

b) Title of Entry: WisCANSin CANpital

c) Brief description of Structure:

The heart of Madison in many respects is the Capital building and since this is the first of what we hope to be many years for Construction in Madison, we thought it only fitting to stick with a Madison theme. Thus the WisCANSin CANpital was born. Since the Capital building often changes appearance based on the time of day and variations in the color of the sky we thought it would be interesting to divide the capital in two and provide a different backdrop on each side so viewers could feel as though they're moving from day to night as they walk around it. The cans on this backdrop will be strategically placed to represent the colors of the sky in the images shown above.

d) Team Member Names:

Vaidas Aksomas

Cody Axness

Megan Compton

Tina Hopwood

Sam Kellerman

Erin Mumm (Team Leader)

Steve Pearl